



# Smith Academy Park

## Landscape Rehabilitation

Martha Lyon Landscape Architecture, LLC  
July 2014

“Charity proceeds from the heart.”

-Sophia Smith, 1866.



# The Park Site in History



1854

Main Street was part of a long, linear common with the future park site at the geographic center; similar linear commons stood in many towns along the Connecticut River



1873

Many homes lined Main Street; the future park site became part of the town's civic core

# The Park Site in History



1888-1889



1908



1910



After 1908



# The Park Site in History

1982, prior to  
demolition  
(trussing details  
have been removed)



1983, dedication  
of new park  
(earthen berms  
are built to create  
“space”)



# The Park Today

## Context & Views

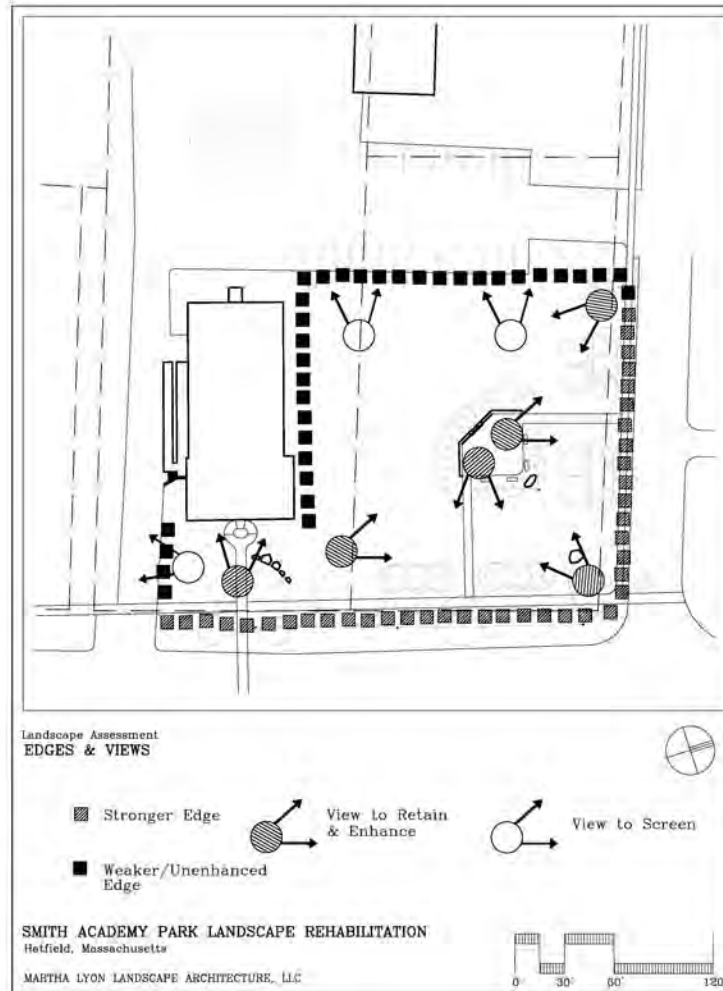

- Strongest edges lie along Main and School Streets, defined by shade trees
- Weaker edges line the west and south sides
- Low-growing tree limbs and overgrown shrubs obscure views into and out of the park





# The Park Today

## Entrances & Circulation

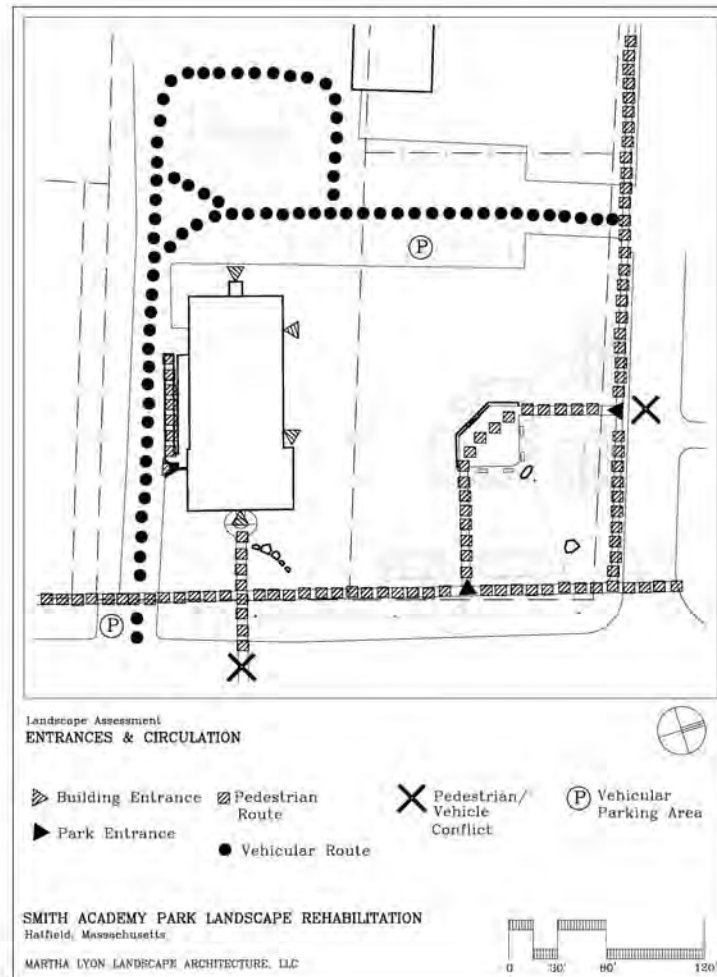

- Park is part of “the loop” or “ the block”
- Most pedestrians walk along the edges and not through the center
- Vehicles are separated from pedestrians
- Conflict areas are present at crosswalks



# The Park Today

## Plants

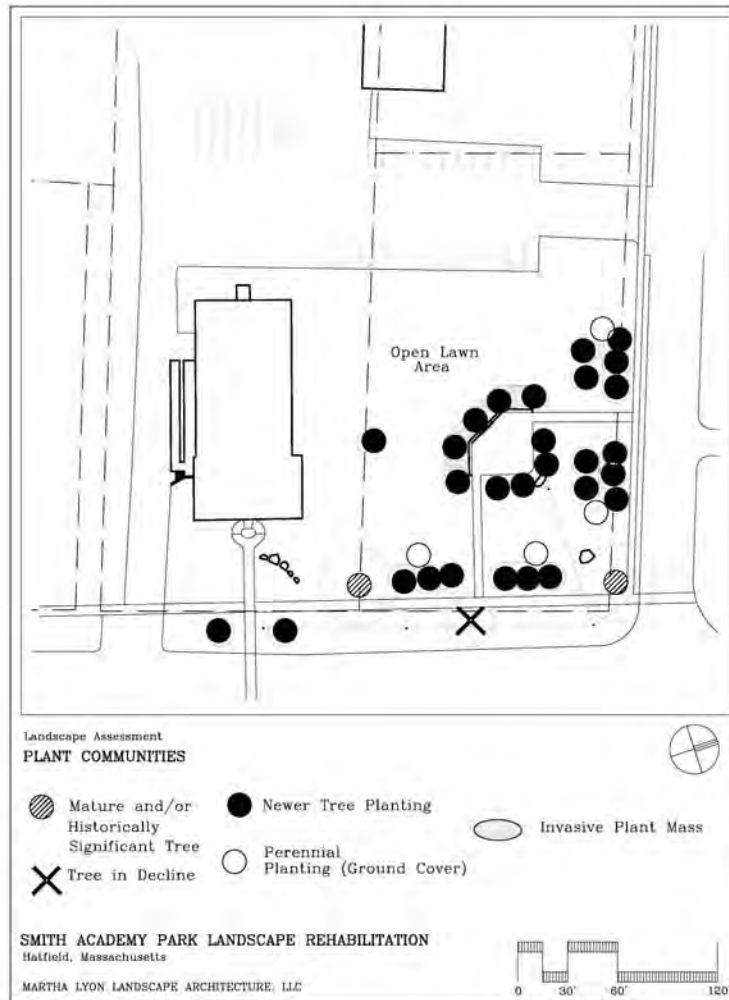

- Two significant trees growing along the Main Street edge; Sycamore a native species
- Interior trees with dense, low-hanging canopies
- Interior shrubs overgrown and perceived as unsafe





# The Park Today

## Details

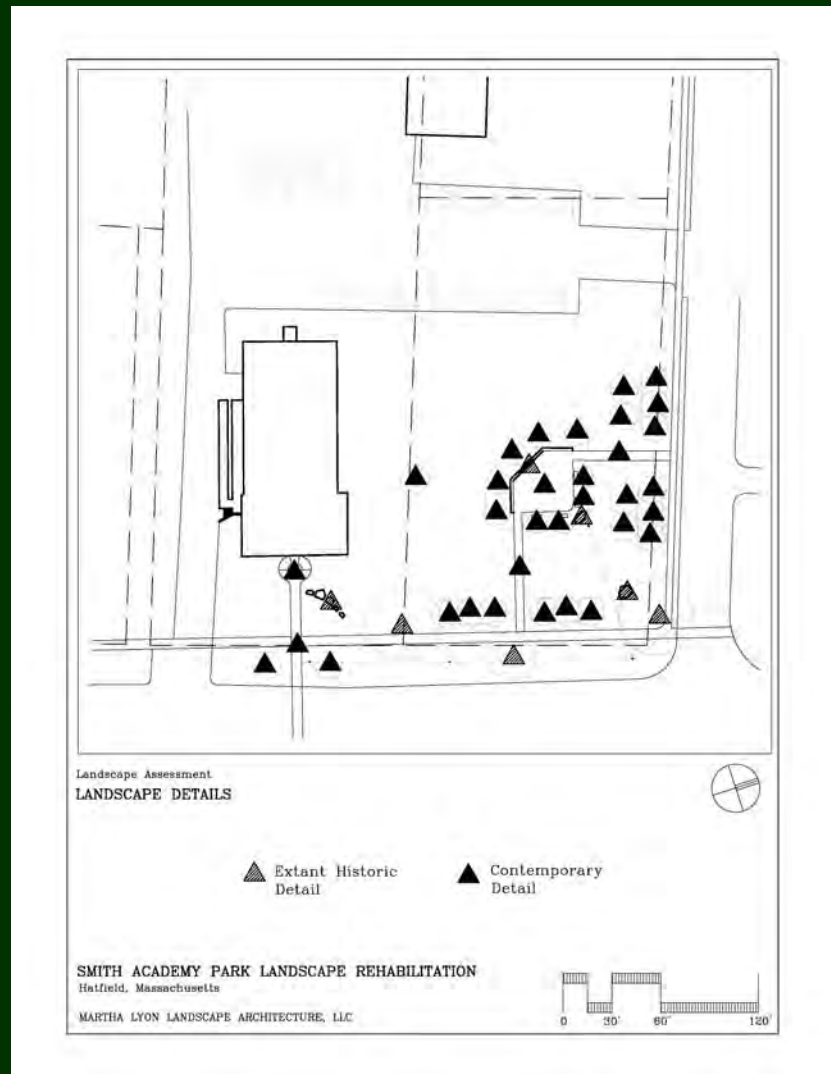

- Few historic features remain
- Many contemporary features have been added
- Contemporary features clutter the park landscape



# Hatfield Voices

*some thoughts from park users, caretakers, historians...*

**What would you like to have in  
the Smith Academy Park ??**

*Beauty*

- The park should connect to surrounding facilities, including the Town Hall, Capawonk Village, Center School, and be a stopping and resting place for pedestrians walking the “loop” or “block”
- The park could be a back/front yard to be used by Seniors, especially those living at Capawonk
- The area in front of Town Hall should be reserved for the Veterans’ memorials, but the stones may be re-arranged, and more may be added in the future
- The park would be used more if people could see through it – people don’t feel safe inside, and the low shrubbery attracts bugs!
- A large, open lawn is important – it can be used for many gatherings and events
- A fountain would be lovely, especially if allowed to take the form of an ice sculpture in winter (like South Deerfield’s)
- Don’t forget trash bins and bike racks



# Landscape Program

- Restore **VIEWS** into and out of the park.
- Retain the **CORNERSTONE** and other commemorative features.
- Rethink **CIRCULATION** paths.
- Provide ample amount of **SEATING**.
- Provide a setting for a **BANDSTAND**.
- Redesign the **PLANTING** so that it provides shade but also permits visibility.
- Allow for the addition of event-related **FEATURES**, including a tent lawn.



# Bandstand Structures



Suffield, CT



Portland, ME



Groveland, MA



Rehoboth, DE



Fairlee, VT



Milton, MA



# Hatfield's Architectural Styles





# Hatfield's Architectural Details





# Concept #I



- Overall circulation pattern reflecting 1888-1889 lithograph of Smith Academy Park site
- 25' x 25' bandstand or pavilion set on slight rise (18") at geographic center of park with Smith Academy building frieze incorporated into structure/setting
- Smith Academy site boulder relocated to area in front (east side) of bandstand
- Four out of six existing lindens on north side of park retained, and limbed to 15' above the ground
- Screening of evergreen trees along west side (parking lot area)
- 5' wide walkways throughout

# Concept #2



- Overall circulation pattern allowing for maximum green space inside park; connecting to existing “loop” or “block” walk through Hatfield
- 15’ x 35’ bandstand or pavilion structure located at western end of park atop a slight rise (18”); Structure designed in tobacco barn style; Smith Academy frieze incorporated into design of setting/structure
- Evergreen screen behind (west side) of pavilion
- Smith Academy boulder relocated to center front of park (east side)
- Berms and lindens completely removed
- 5’ walks throughout park



# Concept #3



- Overall circulation pattern and orientation of park facing northward, toward School Street
- 20' x 30' bandstand/pavilion located near Town Hall on slight rise (18"); Smith Academy frieze and boulder incorporated into setting
- Tall shade trees planted between bandstand/pavilion and Town Hall
- Fountain or water feature located opposite bandstand near north end of park
- Evergreen screen along parking lot (west side)
- Two out of six lindens retained along School and Main Streets, and additional shade tree planted between each set of two lindens
- 5' wide walks throughout; 6' "promenade" walk leading from fountain to bandstand

# Thank You

Kathie Gow, Hatfield Historical Society

George Ashley

Jane Betsold & Hatfield's Seniors

Phil Genovese

Bryan Nicholas

Ed Jaworski

Peter Rakelbusch

Chief Thomas Osley

Wilma Davis & Lydia Szych

Smith Academy